

## EVO LITE

**DESCRIPTION:** Shower system with drainage channel and easy-to-install pipe connector. Compatible with mortar bed and the presloped W-S Heavy Duty Shower Tray system.

**NORMATIVE REFERENCES:** ASME A112.18.2-2020/CSA B125.2:20, ASME A112.6.3-2019  
IAPMO PS 106-2015

**MANUFACTURER:** GURU USA L.L.C.

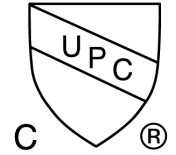

### REFERENCES:

REF.	DESCRIPTION	SIZE	MODEL	FINISH
IDU7011	EVO LITE	4"	PLUS	BRUSHED
IDU7012	EVO LITE	4"	PLUS	NERO
IDU7013	EVO LITE	4"	PLUS	POLISHED
IDU7014	EVO LITE	4"	PLUS	GOLD
IDU7015	EVO LITE	4"	PLUS	BRONZE
IDU7016	EVO LITE	4"	PLUS	NICKEL CHAMPAGNE
IDU7017	EVO LITE	4"	PLUS	WHITE

REF.	DESCRIPTION	SIZE	MODEL	FINISH
IDU7007	EVO LITE	4"	SQUARE	NICKEL CHAMPAGNE
IDU7008	EVO LITE	4"	SQUARE	NERO

IDU7009	EVO LITE	4"	SPIGA	NICKEL CHAMPAGNE
IDU7010	EVO LITE	4"	SPIGA	NERO



### TEST TABLE:

CHARACTERISTICS	METHOD	VALUE
Thermal cycling	5.3	Pass
Coatings	5.4	Pass
Load test	552	Pass
Flow rate	5.8	> 8.0 gpm

### INCLUDED ELEMENTS:

- » **GRATE:** Made of 3/32" marine grade stainless steel.
- » **DRAIN:** Lowest height drain 1<sup>7</sup>/<sub>8</sub>" made of ABS.
- » **ADAPTER:** A push-in resilient connection for the most common clamping ring shower drains.
- » **HAIR STRAINER:** Premium ABS hair-strainer included.

COMPONENTS:

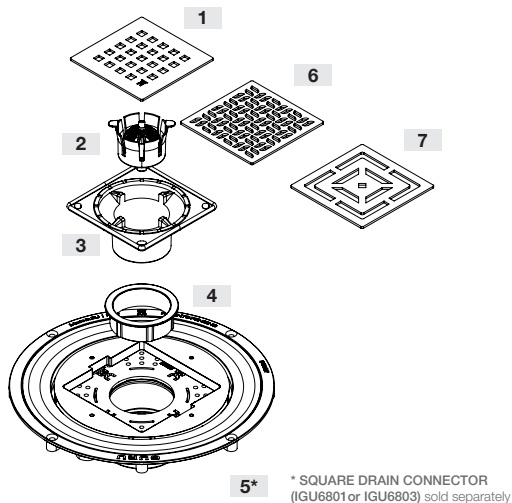

PIECE	DESCRIPTION	MATERIAL
1	PLUS GRATE	AISI 304
2	HAIR STRAINER	ABS
3	DRAIN	ABS
4	ADAPTER	SBS
5	SQUARE DRAIN CONNECTOR*	ABS/PVC
6	SPIGA GRATE	AISI 304
7	SQUARE GRATE	AISI 304

\*1 SQUARE DRAIN CONNECTOR (IGU6801 or IGU6803) sold separately

MAINTENANCE:

Ensuring the longevity and optimal performance of EVO LITE is remarkably hassle-free, as these products demand no specialized maintenance and exhibit resistance to mold and fungi. When necessary, the drain grates can be effortlessly removed for the cleaning of both the drain housing and pipes.

For routine cleaning of the grates and profiles, utilize neutral cleaners to preserve their integrity. It is imperative to steer clear of potent acids (such as hydrochloric or hydrofluoric) and strong bases or alkaline cleaners (including bleach, ammonia, and chlorides). Avoid abrasive cleaning agents and tools to prevent any potential damage.

Even stainless steel, renowned for its durability, benefits from periodic cleaning. This not only sustains a pristine appearance but also mitigates the risk of corrosion. Applying a chrome-polishing agent imparts a subtle sheen to stainless steel surfaces, contributing to their overall aesthetic appeal.

## TECHNICAL DRAWINGS:

### DRAIN

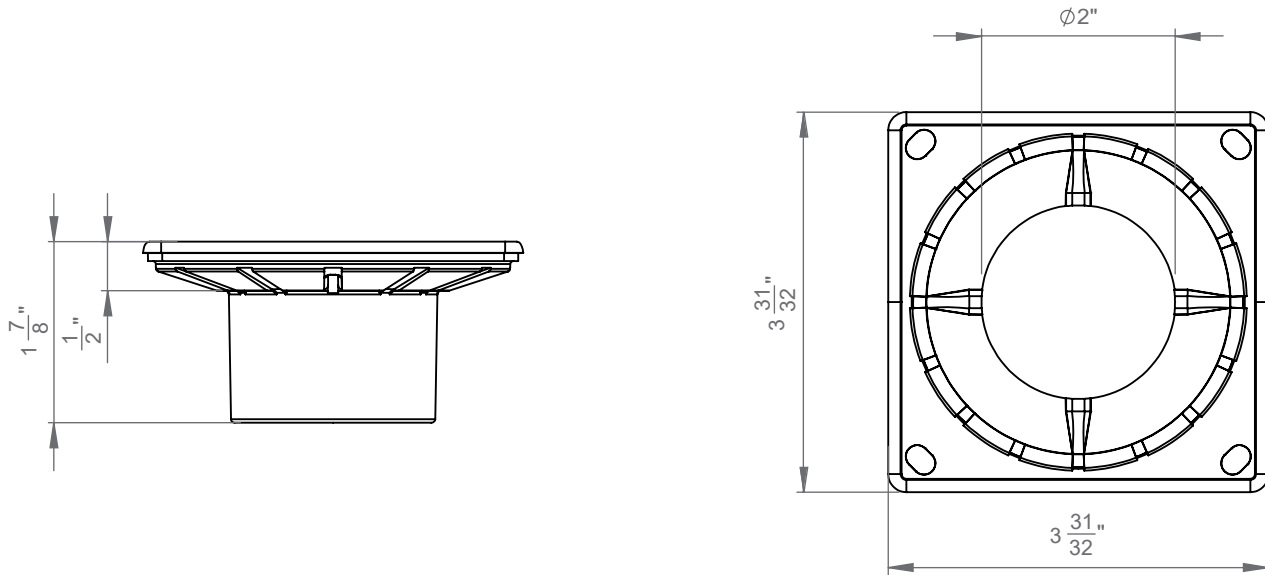

### EVO LITE PLUS

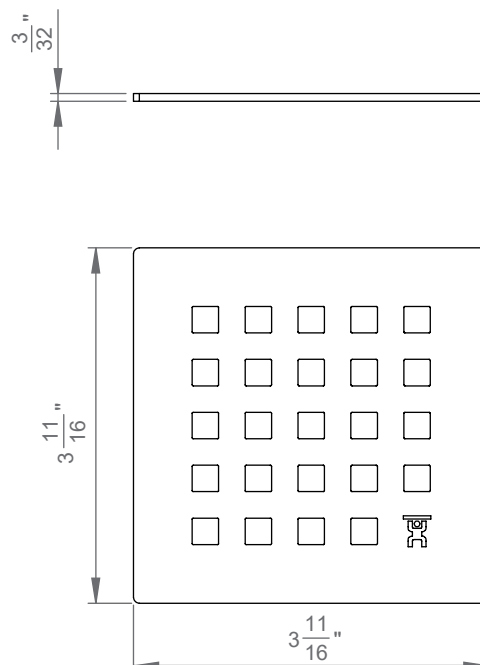

*Measurements are in inches*

## TECHNICAL DRAWINGS:

### EVO LITE SPIGA

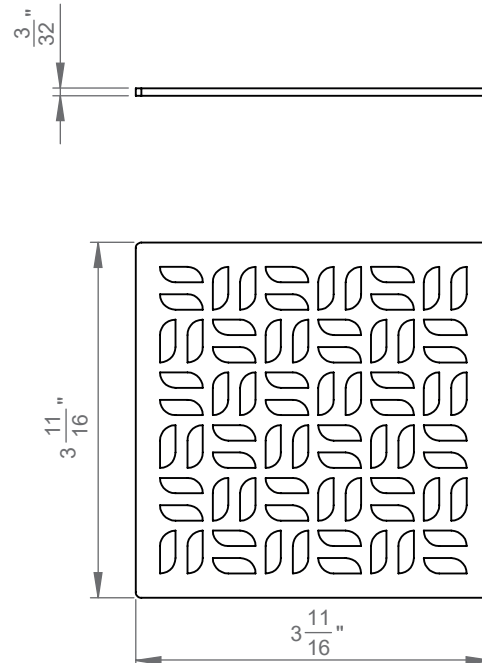

*Measurements are in inches*

### EVO LITE SQUARE

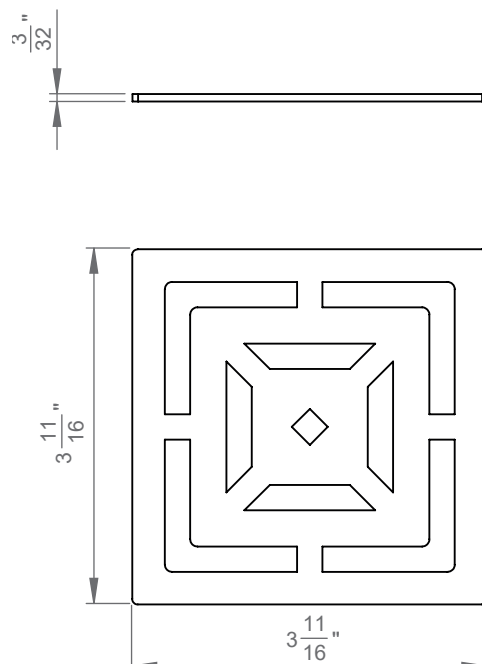

*Measurements are in inches*