

## EVOLUX INTEGRA

**DESCRIPTION:** Tileable shower system with drainage channel and easy-to-install pipe connector. Compatible with mortar bed and the presloped W-S Heavy Duty Shower Tray system.

**NORMATIVE REFERENCES:** ASME A112.18.2-2020/CSA B125.2:20, ASME A112.6.3-2019  
IAPMO PS 106-2015

**MANUFACTURER:** GURU USA L.L.C.

### REFERENCES:

REF.	DESCRIPTION	SIZE	MODEL
IDU3504	EVOLUX	4"	INTEGRA



### TEST TABLE:

CHARACTERISTICS	METHOD	VALUE
	ASME A112.18.2-2020	
Thermal cycling	5.3	Pass
Coatings	5.4	Pass
Load test	5.5.2	Pass
Flow rate	5.8	> 8.0 gpm

### INCLUDED ELEMENTS:

- » **TILEABLE GRATE:** Allows the drain to be finished with the same tile as the surrounding area.
- » **HAIR STRAINER:** Premium ABS hair-strainer included.
- » **DRAIN:** Low profile drain 3/8" height made of marine grade stainless steel, 16 gauges.
- » **ADAPTER:** A push-in resilient connection for the most common clamping ring shower drains.

COMPONENTS:

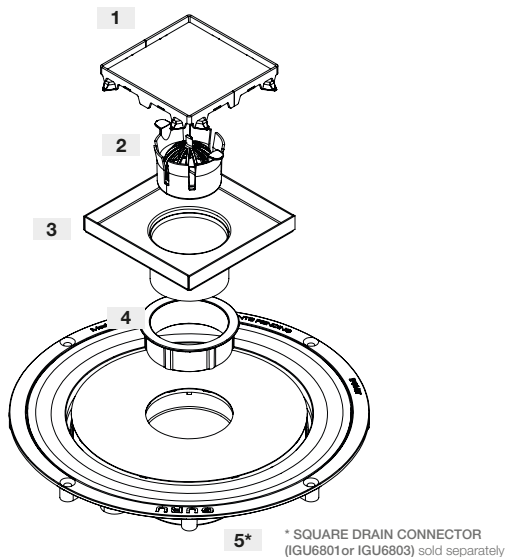

PIECE	DESCRIPTION	MATERIAL
1	TILEABLE GRATE	AISI 316
2	HAIR STRAINER	ABS
3	DRAIN	AISI 316
4	ADAPTER	SBS
5	SQUARE DRAIN CONNECTOR*	ABS/PVC

\*1 SQUARE DRAIN CONNECTOR (IGU6801 or IGU6803) sold separately

MAINTENANCE:

Ensuring the longevity and optimal performance of EVOLUX is remarkably hassle-free, as these products demand no specialized maintenance and exhibit resistance to mold and fungi. When necessary, the drain grates can be effortlessly removed for the cleaning of both the drain housing and pipes.

For routine cleaning of the grates and profiles, utilize neutral cleaners to preserve their integrity. It is imperative to steer clear of potent acids (such as hydrochloric or hydrofluoric) and strong bases or alkaline cleaners (including bleach, ammonia, and chlorides). Avoid abrasive cleaning agents and tools to prevent any potential damage.

Even stainless steel, renowned for its durability, benefits from periodic cleaning. This not only sustains a pristine appearance but also mitigates the risk of corrosion. Applying a chrome-polishing agent imparts a subtle sheen to stainless steel surfaces, contributing to their overall aesthetic appeal.

## TECHNICAL DRAWINGS:

### DRAIN

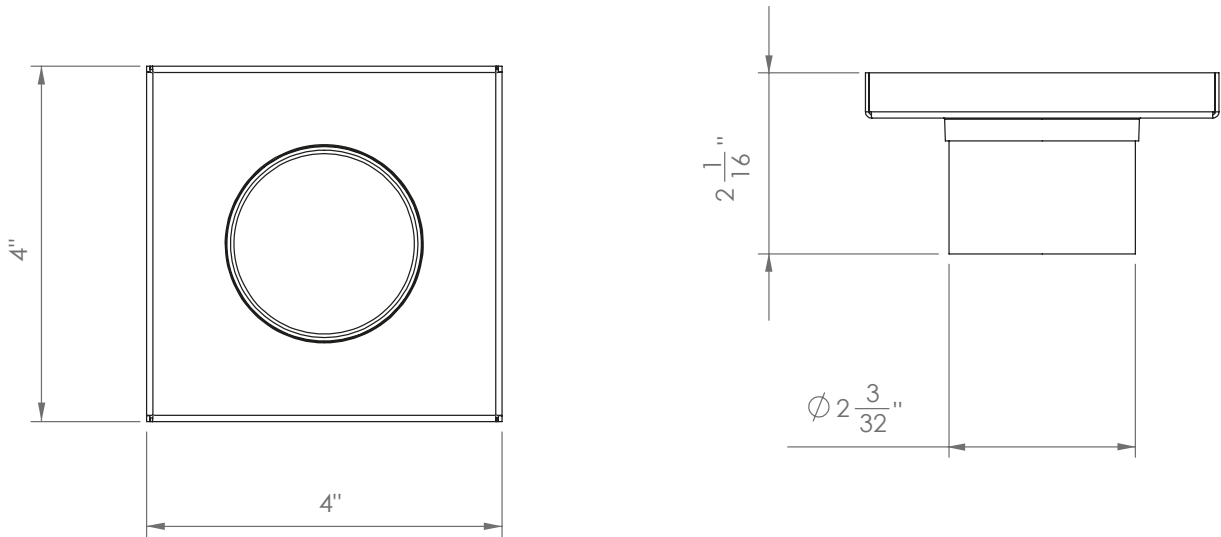

### TILEABLE GRATE

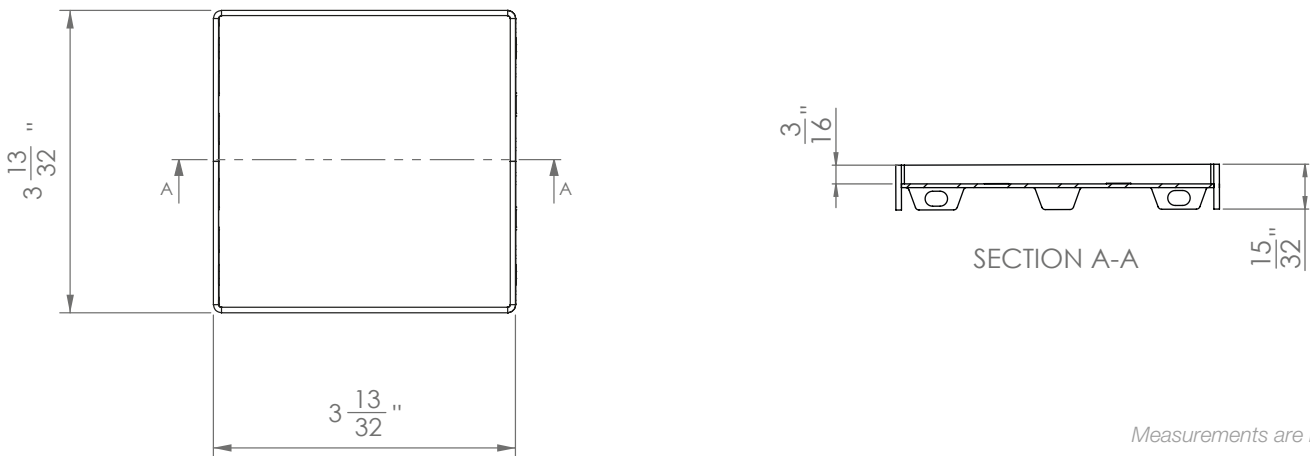

Measurements are in inches